

THE CITY OF NAPOLEON

BUILDING & ZONING DEPARTMENT

255 W. RIVERVIEW

(419)592-4010

Building Permit

Permit Number: BP2007-68

Page 1 of 1

Printed: 5/10/2007

ADDRESS:

828 Main St. W.

Applicant

Name: Ethel Lambert

Address: 828 W Main St

Approval Date: 5/10/2007

419-592-4761

Owners

Name: Ms. Ethel Lambert

Address: 828 W Main St

Napoleon, OH 43545

Phone: 419-592-4761

Contractors

Fees and Receipts:

Number

Description

Amount

Total Fees: _____ **\$0.00**

Total Receipts: _____ **\$0.00**

replacing wooden deck w/ concrete

APPLICANTS SIGNATURE: _____ DATE: _____

REMINDER: YOU MUST CALL (419)592-4010 FOR AN INSPECTION

CITY OF NAPOLEON GENERAL PERMIT APPLICATION

THIS APPLICATION IS FOR RESIDENTIAL CONSTRUCTION INCLUDING BUILDING, ELECTRICAL, PLUMBING, MECHANICAL, DEMOLITIONS, REMODELING.

DATE: 5-10-07 JOB LOCATION: 828 W MAIN ST

OWNER: Jerry Snavel PHONE: 758 3442

OWNER ADDRESS: 828 W MAIN ST CITY: Napoleon ZIP: 43545

CONTRACTOR: Myself

PHONE #: 758-3442 CELL PHONE#: _____

CONTRACTOR LICENSED WITH THE CITY OF NAPOLEON?: YES NO:

Is any of the above job going to be subcontracted out? Yes No:

If yes to whom: _____

DESCRIPTION OF WORK TO BE PERFORMED: _____

ESTIMATED COMPLETION DATE: _____

PLEASE MARK THE TYPE OF WORK YOU WILL BE PERFORMING

- | | |
|---|--|
| <input type="checkbox"/> A/C ADD ON | <input type="checkbox"/> REMODELING |
| <input type="checkbox"/> BOILER REPLACEMENT | <input type="checkbox"/> ROOFING |
| <input type="checkbox"/> CURBING | <input type="checkbox"/> SEWER REPAIRS** |
| <input type="checkbox"/> DECKS * | <input type="checkbox"/> SIDEWALK* |
| <input type="checkbox"/> DRIVEWAY* | <input type="checkbox"/> SIDING |
| <input type="checkbox"/> ELECTRICAL SERVICE UPGRADE | <input type="checkbox"/> STORAGE SHED* |
| <input type="checkbox"/> ELECTRICAL SERVICE NEW | <input type="checkbox"/> SWIMMING POOL* |
| <input type="checkbox"/> FENCE* | <input type="checkbox"/> FURNACE REPLACEMENT |
| <input type="checkbox"/> ADDITIONS* | <input type="checkbox"/> TEMP ELECTRIC |
| <input type="checkbox"/> FURNACE NEW | <input type="checkbox"/> WATER TAP (size _____") |
| <input type="checkbox"/> LAWN METER | <input type="checkbox"/> WINDOWS |
| <input type="checkbox"/> PLUMBING | <input type="checkbox"/> ZONING |

*PLEASE INCLUDE A PICTURE SHOWING MEASUREMENTS FROM EXISTING STRUCTURES AND PROPERTY LINES. INDICATING THE TYPE OF WORK YOU WISH TO PERFORM.

** IF WORK REQUIRES GOING INTO THE STREET A STREET BOND IS REQUIRED!

FOR PERMIT COSTS PLEASE FILL OUT REVERSE SIDE.

828 W Martin

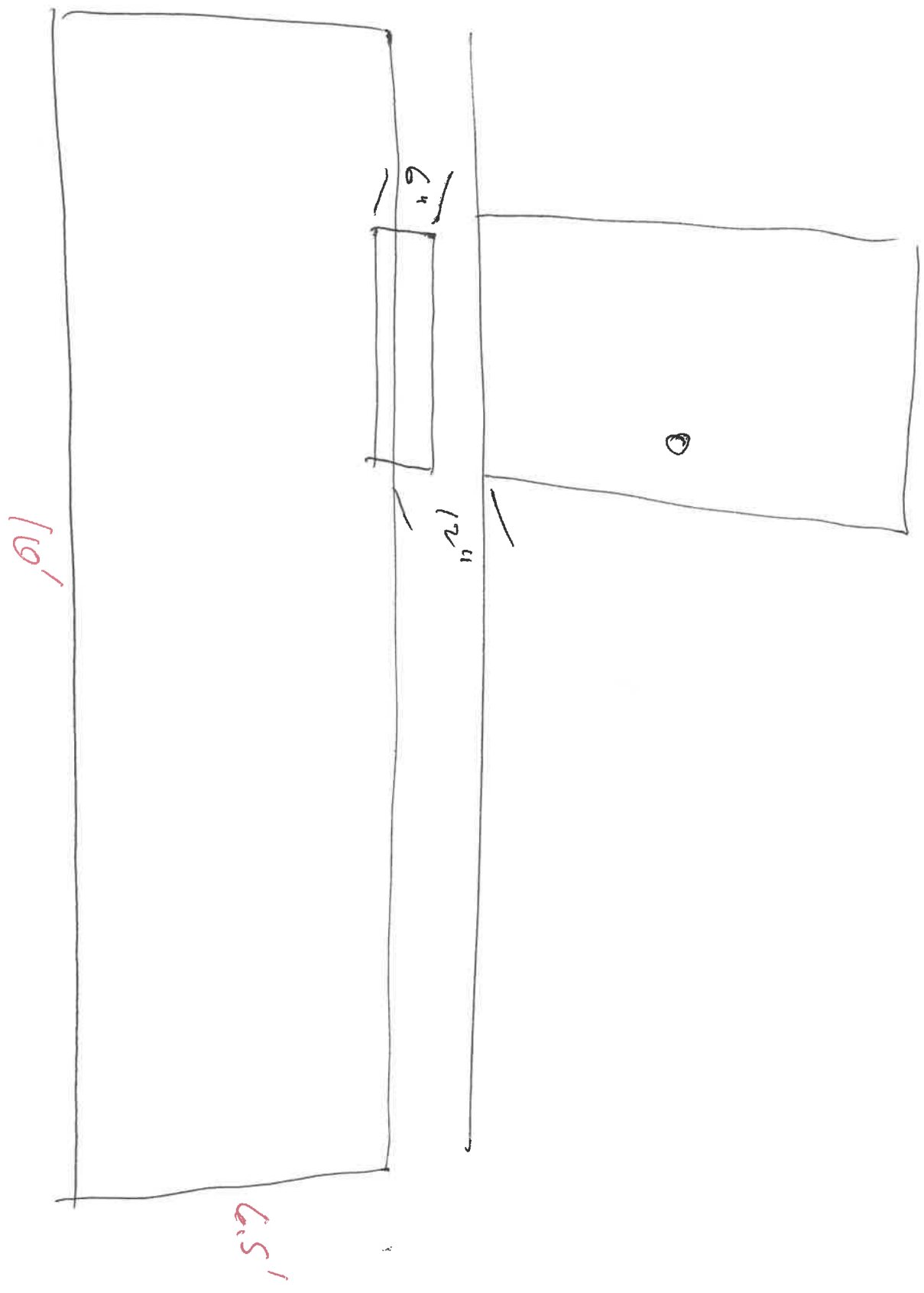

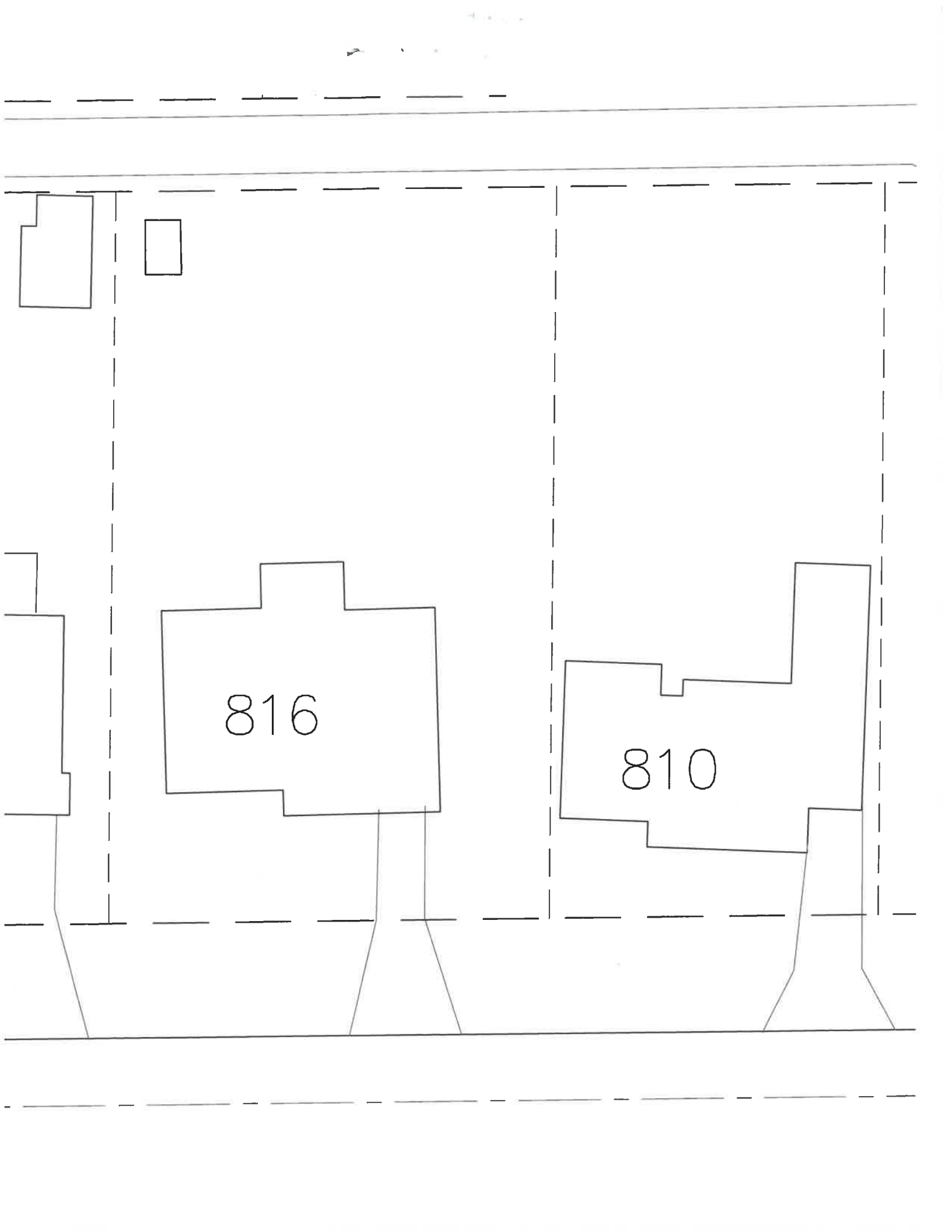

F

THE CITY OF NAPOLEON
BUILDING & ZONING DEPARTMENT
255 W. RIVERVIEW
(419)592-4010



Inspections

Page 1 of 1

Address: 828 Main St. W.
Napoleon, OH 43545

Printed: 5/11/2007

Applicant: Ethel Lambert

Permit Number: BP2007-68

Inspection Date: 5/11/2007
Inspection Number: INSP2007-119
Inspection Type: Building Final

Inspector: Tom Zimmerman
Status: Complete
Passed?

Required Steps:

Comments:

Other Fields: